

1 AREA 2 - FLOOR PLAN
1/8" = 1'-0"

GENERAL NOTES:

- WHERE EXISTING THERMOSTATS ARE BEING REMOVED FROM EXISTING WALLS, SEE MECHANICAL DRAWINGS. COVER OPENING WITH METAL PLATE, PRIME AND PAINTED TO MATCH WALL.
- AT PATCHED AND REPAIRED WALL AREAS, PAINT WALL, FIND EVEN CONTINUOUS LINE OF DEMARCATION FOR NEW PAINT, BLEND WITH EXISTING SO THAT NOT VISIBLE. PATCHES OF NEW AND EXISTING PAINT.
- ALL MEP COMPONENTS ARE SHOWN FOR REFERENCE ONLY. SEE MEP DRAWINGS.

KEY NOTES:

- PATCH AND REPAIR FLOORING AS NEEDED FROM REMOVAL OF EXISTING MECHANICAL UNIT - VERIFY EXTENT IN FIELD.
- BLOCK EXISTING EXTERIOR LOUVER FROM INSIDE AFTER REMOVAL OF EXISTING MECHANICAL UNIT - SEE ELEVATION AND DETAIL.
- PROVIDE MECHANICAL LOUVER IN WINDOW UNIT - SEE ELEVATION AND MECHANICAL DRAWINGS.
- SAWCUT EXISTING EXTERIOR MASONRY FOR NEW MECHANICAL LOUVER. ALIGN SAWCUT WITH EXISTING MASONRY JOINTS, APPROXIMATELY 3/8" x 3/2" - SEE STRUCTURAL DRAWINGS FOR Lintel SIZING - SEE ELEVATION AND MECHANICAL DRAWINGS.
- REMOVE (2) SECTIONS OF EXISTING SHELVING, SALVAGE FOR REINSTALLATION. PATCH AND REPAIR FLOORING AND WALL AS NEEDED.
- REINSTALL SALVAGED SHELVING TO THIS LOCATION. NEW MECHANICAL UNIT, SHOW FOR REFERENCE - SEE MECHANICAL DRAWINGS.
- BASE BID: REMOVE EXISTING MINI BLINDS, SALVAGE AND RETURN TO OWNER. PROVIDE NEW ROLLER SHADES AT NEW GLAZING - SEE SPECIFICATIONS.
- BASE BID: REMOVE EXISTING MINI BLINDS, SALVAGE-STORE, CLEAN AND REINSTALL AT END OF PROJECT.
- ADD ALTERNATE: REMOVE EXISTING MINI BLINDS, SALVAGE AND RETURN TO OWNER. PROVIDE NEW ROLLER SHADES AT NEW GLAZING - SEE SPECIFICATIONS.
- PROVIDE NEW ABRASIVE ACTION FLOORING AT BUILDING ENTRIES.
- SAND BLAST #2 SURFACE AT ROOMS 12C AND 12D - SEE SPECIFICATIONS.
- NEW CARPET AT CORRIDORS - SEE SPECIFICATIONS.
- IF ALTERNATE IS TAKEN, PATCH AND REPAIR FLOORING AS NEEDED FROM REMOVAL OF EXISTING MECHANICAL UNIT - VERIFY EXTENT IN FIELD.
- REMOVE EXISTING GLAZING AND INTERIOR MULLIONS. PROVIDE MECHANICAL LOUVER IN WINDOW UNIT - SEE ELEVATION AND MECHANICAL DRAWINGS.
- NEW ACCESS PANEL AT ISOLATION VALVES, VERIFY LOCATION IN FIELD - SEE MECHANICAL DRAWINGS.
- EXISTING MECHANICAL PIPING AND NEW ISOLATION VALVES BELOW FLOOR, VERIFY IN FIELD - SEE MECHANICAL DRAWINGS.
- SAWCUT EXISTING SUBFLOOR AS NEEDED TO COMPLETE PIPING WORK. REPLACE WITH NEW 3/4" T&G SUBFLOOR.
- NEW CARPET, PATCH AND REPAIRS AS REQUIRED, VERIFY EXTENT IN FIELD.
- EXISTING MASONRY WALL, SHOWN FOR REFERENCE.

DOOR TAG LEGEND

- 123 NO WORK - SHOWN FOR REFERENCE ONLY
- 123 NEW HARDWARE ONLY
- 123 NEW DOOR, HARDWARE AND/OR FRAME

NOTE: SEE DOOR SCHEDULE AND SPECIFICATIONS

NEW FLOORING LEGEND

- NEW CARPET, SEE SPECIFICATIONS
- NEW ABRASIVE ACTION FLOORING, SEE SPECIFICATIONS

NOTE: SF SHOWN ON PLANS IS APPROXIMATE, GC TO FIELD VERIFY EXACT SF REQUIRED

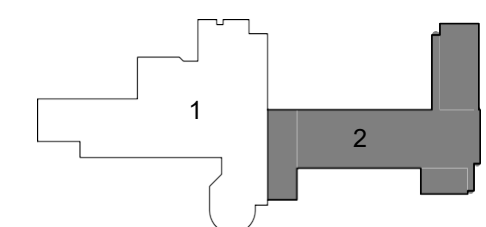

100% CONSTRUCTION DOCUMENTS

NO.	BY	DATE	DESCRIPTION	REVISIONS
1	AL	02.03.16		

DATE: 02.03.16
SHEET NO.:
A1.2