

- NOTES:
- EXISTING GRANULATED SURFACE COATING OVER EXISTING SPRAY POLYURETHANE FOAM INSULATION. POWER WASH AND CLEAN EXISTING COATING PRIOR TO APPLICATION OF NEW COATING. REMOVE AND DISPOSE OF ALL LOOSE GRANULES. TYPICAL AT ALL ROOF AREAS.
 - EXISTING COUNTER FLASHING REGLET TO BE DOUBLE-CUT LEAVING 1" TO 2" OF EXISTING MATERIAL.
 - SET NEW 24 GA. PRE-FINISHED COUNTER FLASHING IN NEW CONTINUOUS BED OF SEALANT BEHIND EXISTING RECEIVER.
 - FASTEN RECEIVER AND NEW COUNTER FLASHING TO THE EXISTING SUBSTRATE @ 8" O.C. WITH NEW METAL BACKED FASTENERS WITH NEOPRENE WASHERS.

7 REGLET COUNTER FLASHING (TYPICAL)

SCALE: 3" = 1'-0"

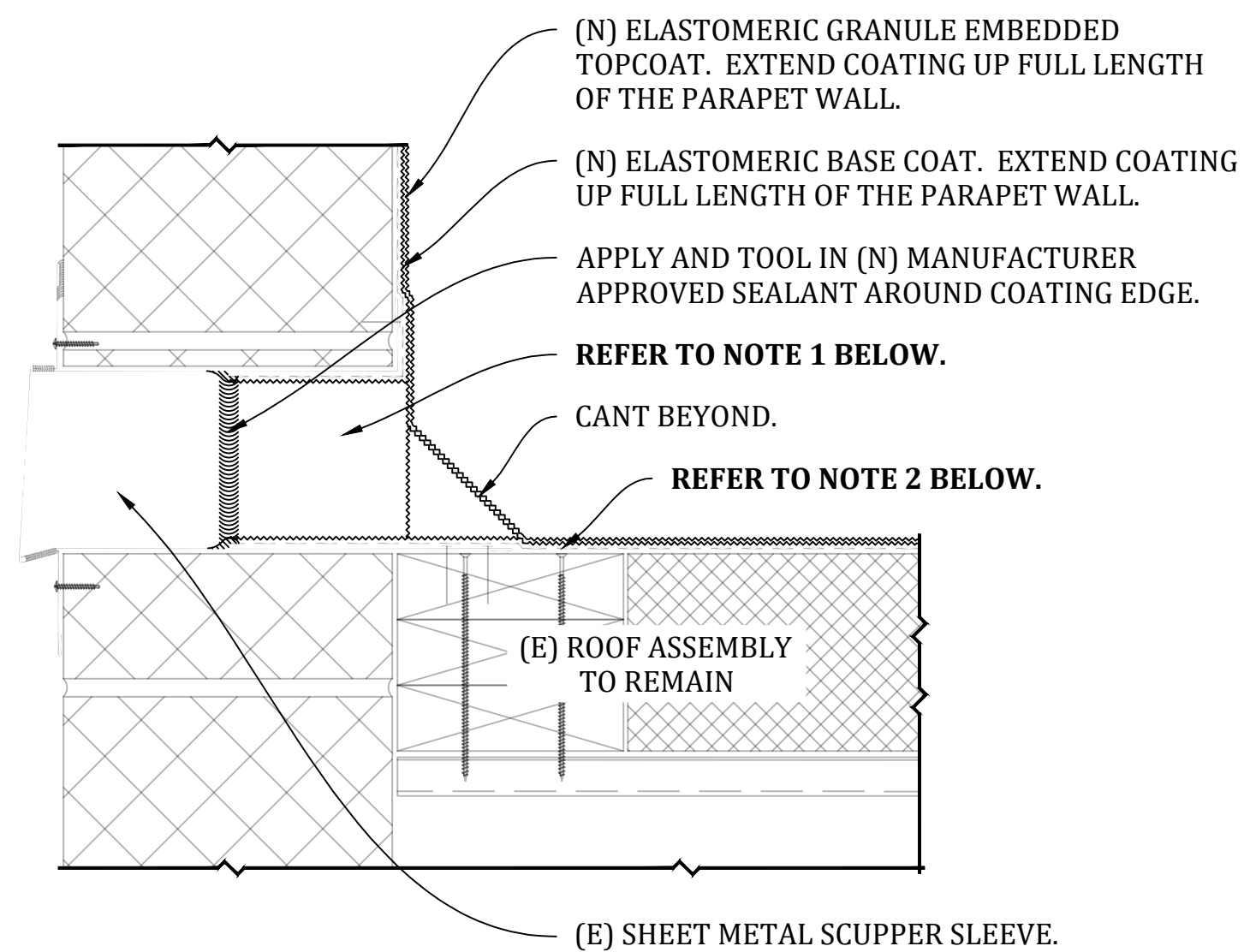

- NOTES:
- REMOVE EXCESS COATING AND GRANULES FROM WITHIN SCUPPER PRIOR TO APPLYING THE NEW COATING TO MAINTAIN SCUPPER OPENING SIZE.
 - EXISTING GRANULATED SURFACE COATING OVER EXISTING SPRAY POLYURETHANE FOAM INSULATION. POWER WASH AND CLEAN EXISTING COATING PRIOR TO APPLICATION OF NEW COATING. REMOVE AND DISPOSE OF ALL LOOSE GRANULES. TYPICAL AT ALL ROOF AREAS.

8 THRU-WALL SCUPPER FLASHING (TYPICAL)

SCALE: 3" = 1'-0"

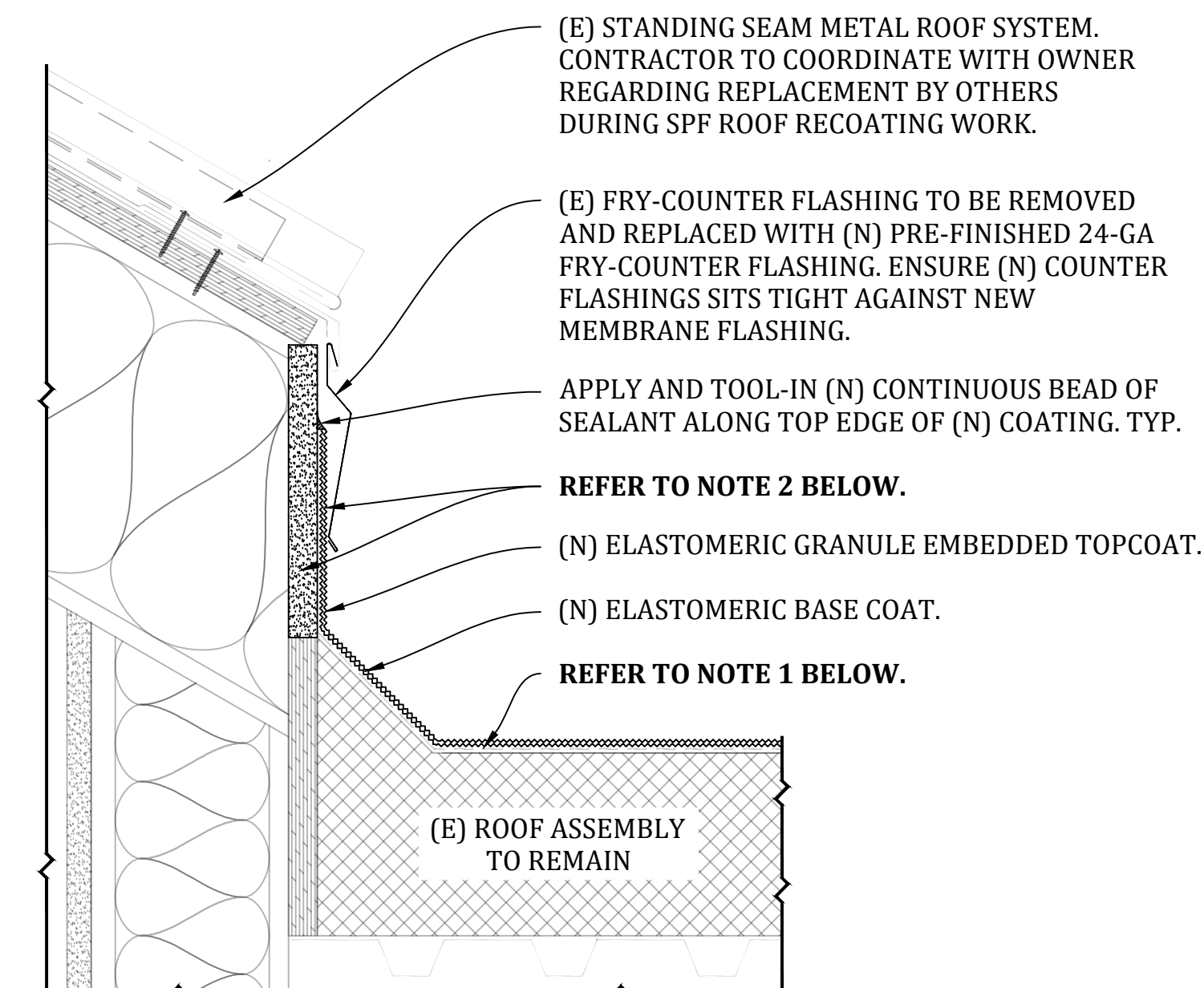

- NOTES:
- EXISTING GRANULATED SURFACE COATING OVER EXISTING SPRAY POLYURETHANE FOAM INSULATION. POWER WASH AND CLEAN EXISTING COATING PRIOR TO APPLICATION OF NEW COATING. REMOVE AND DISPOSE OF ALL LOOSE GRANULES. TYPICAL AT ALL ROOF AREAS.
 - EXISTING SUBSTRATE BOARD AND VERTICAL COATING TO BE REMOVED AND DISPOSED WHERE COATING HAS BECOME DETERIORATED AND DEBONDED. REPLACE SUBSTRATE BOARD WITH NEW GYPSUM SHEATHING, FASTENED TO THE EXISTING SUB-FRAMING @ 12" O.C. APPLY NEW COATING SYSTEM UP VERTICAL FACE OF THE NEW SUBSTRATE BOARD. REFER TO ROOF PLANS FOR REPAIR LOCATIONS.
 - THE INTENT OF THE NOTE 2 REPAIR IS TO PROVIDE A SUITABLE SUBSTRATE FOR THE ROOF SYSTEM TRANSITION AND FLASHING. THIS REPAIR DOES NOT INCLUDE PROTECTION FROM POTENTIAL INTERNAL MOISTURE AS THAT WORK IS UNDERSTOOD TO BE ADDRESSED SEPARATELY AND OUTSIDE THE SCOPE OF THIS PROJECT.

9 FLASHING REPAIR @ LOW SLOPE MONITOR ROOFS (TYPICAL)

SCALE: 3" = 1'-0"

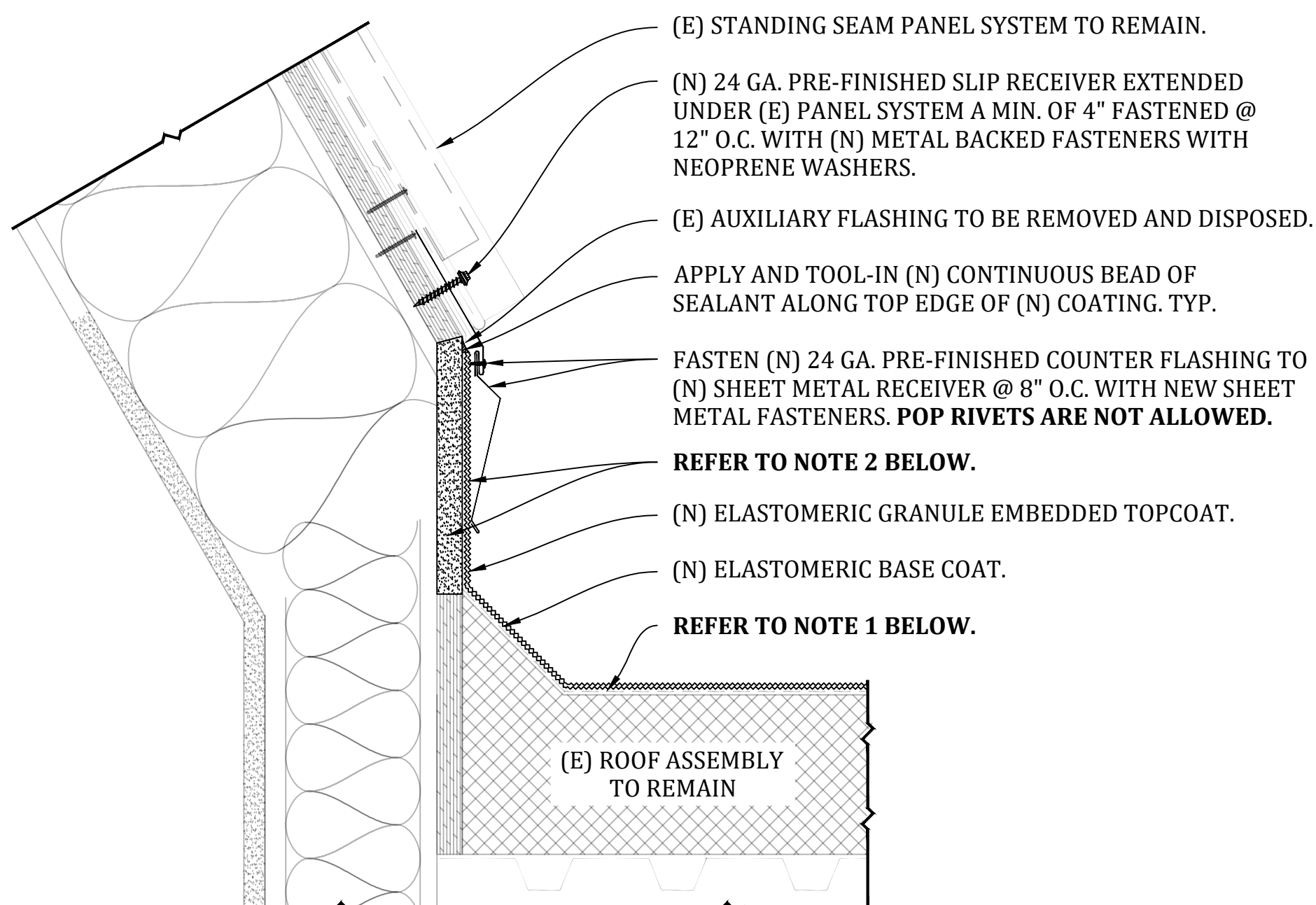

- NOTES:
- EXISTING GRANULATED SURFACE COATING OVER EXISTING SPRAY POLYURETHANE FOAM INSULATION. POWER WASH AND CLEAN EXISTING COATING PRIOR TO APPLICATION OF NEW COATING. REMOVE AND DISPOSE OF ALL LOOSE GRANULES. TYPICAL AT ALL ROOF AREAS.
 - EXISTING SUBSTRATE BOARD AND VERTICAL COATING TO BE REMOVED AND DISPOSED WHERE COATING HAS BECOME DETERIORATED AND DEBONDED. REPLACE SUBSTRATE BOARD WITH NEW GYPSUM SHEATHING, FASTENED TO THE EXISTING SUB-FRAMING @ 12" O.C. APPLY NEW COATING SYSTEM UP VERTICAL FACE OF THE NEW SUBSTRATE BOARD. REFER TO ROOF PLANS FOR REPAIR LOCATIONS.
 - THE INTENT OF THE NOTE 2 REPAIR IS TO PROVIDE A SUITABLE SUBSTRATE FOR THE ROOF SYSTEM TRANSITION AND FLASHING. THIS REPAIR DOES NOT INCLUDE PROTECTION FROM POTENTIAL INTERNAL MOISTURE AS THAT WORK IS UNDERSTOOD TO BE ADDRESSED SEPARATELY AND OUTSIDE THE SCOPE OF THIS PROJECT.

10 FLASHING REPAIR @ STEEP SLOPE MONITOR ROOFS (TYPICAL)

SCALE: 3" = 1'-0"

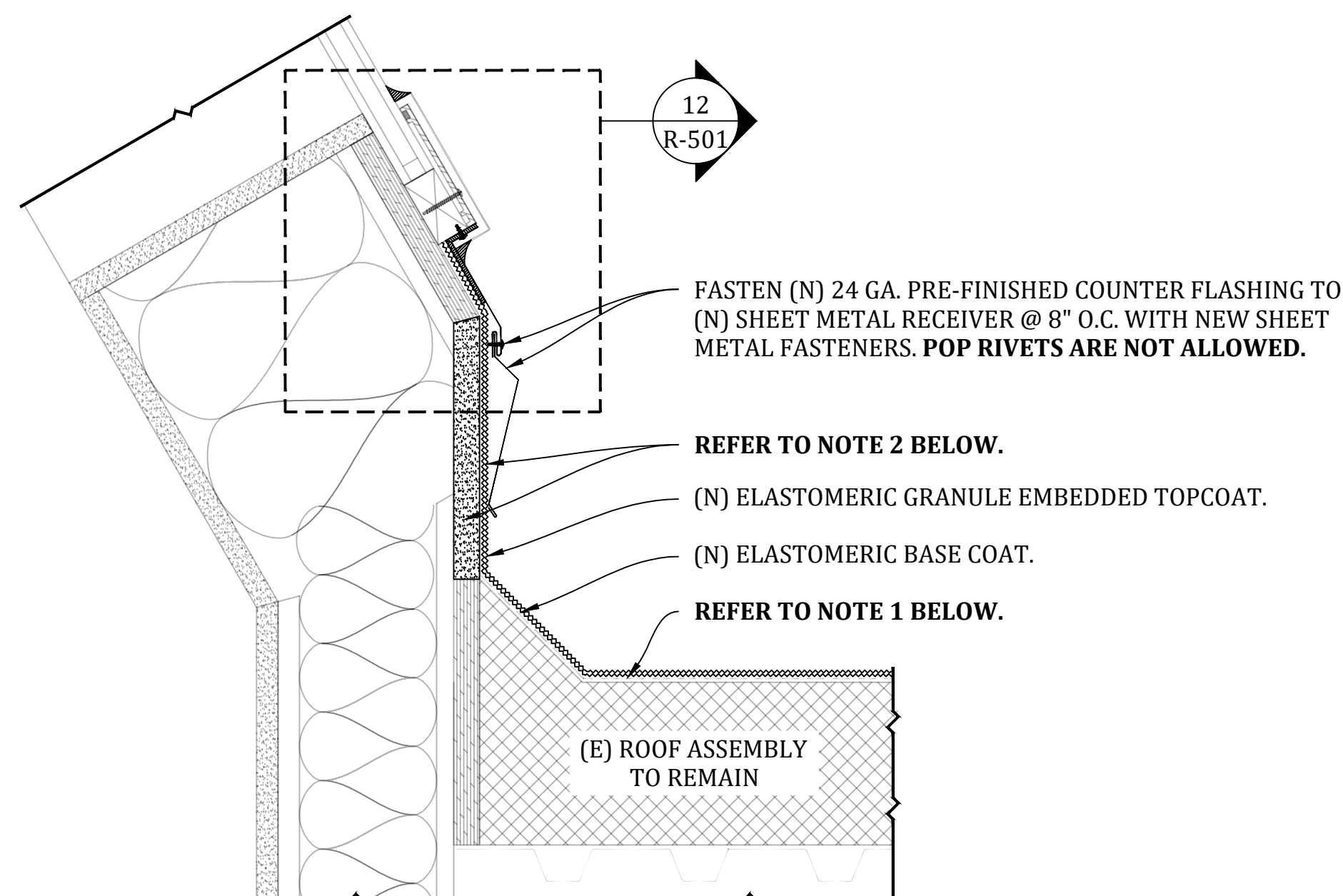

- NOTES:
- EXISTING GRANULATED SURFACE COATING OVER EXISTING SPRAY POLYURETHANE FOAM INSULATION. POWER WASH AND CLEAN EXISTING COATING PRIOR TO APPLICATION OF NEW COATING. REMOVE AND DISPOSE OF ALL LOOSE GRANULES. TYPICAL AT ALL ROOF AREAS.
 - EXISTING SUBSTRATE BOARD AND VERTICAL COATING TO BE REMOVED AND DISPOSED WHERE COATING HAS BECOME DETERIORATED AND DEBONDED. REPLACE SUBSTRATE BOARD WITH NEW GYPSUM SHEATHING, FASTENED TO THE EXISTING SUB-FRAMING @ 12" O.C. APPLY NEW COATING SYSTEM UP VERTICAL FACE OF THE NEW SUBSTRATE BOARD. REFER TO ROOF PLANS FOR REPAIR LOCATIONS.
 - THE INTENT OF THE NOTE 2 REPAIR IS TO PROVIDE A SUITABLE SUBSTRATE FOR THE ROOF SYSTEM TRANSITION AND FLASHING. THIS REPAIR DOES NOT INCLUDE PROTECTION FROM POTENTIAL INTERNAL MOISTURE AS THAT WORK IS UNDERSTOOD TO BE ADDRESSED SEPARATELY AND OUTSIDE THE SCOPE OF THIS PROJECT.

11 FLASHING REPAIR @ MONITOR CLEARSTORY WINDOWS (TYP)

SCALE: 3" = 1'-0"

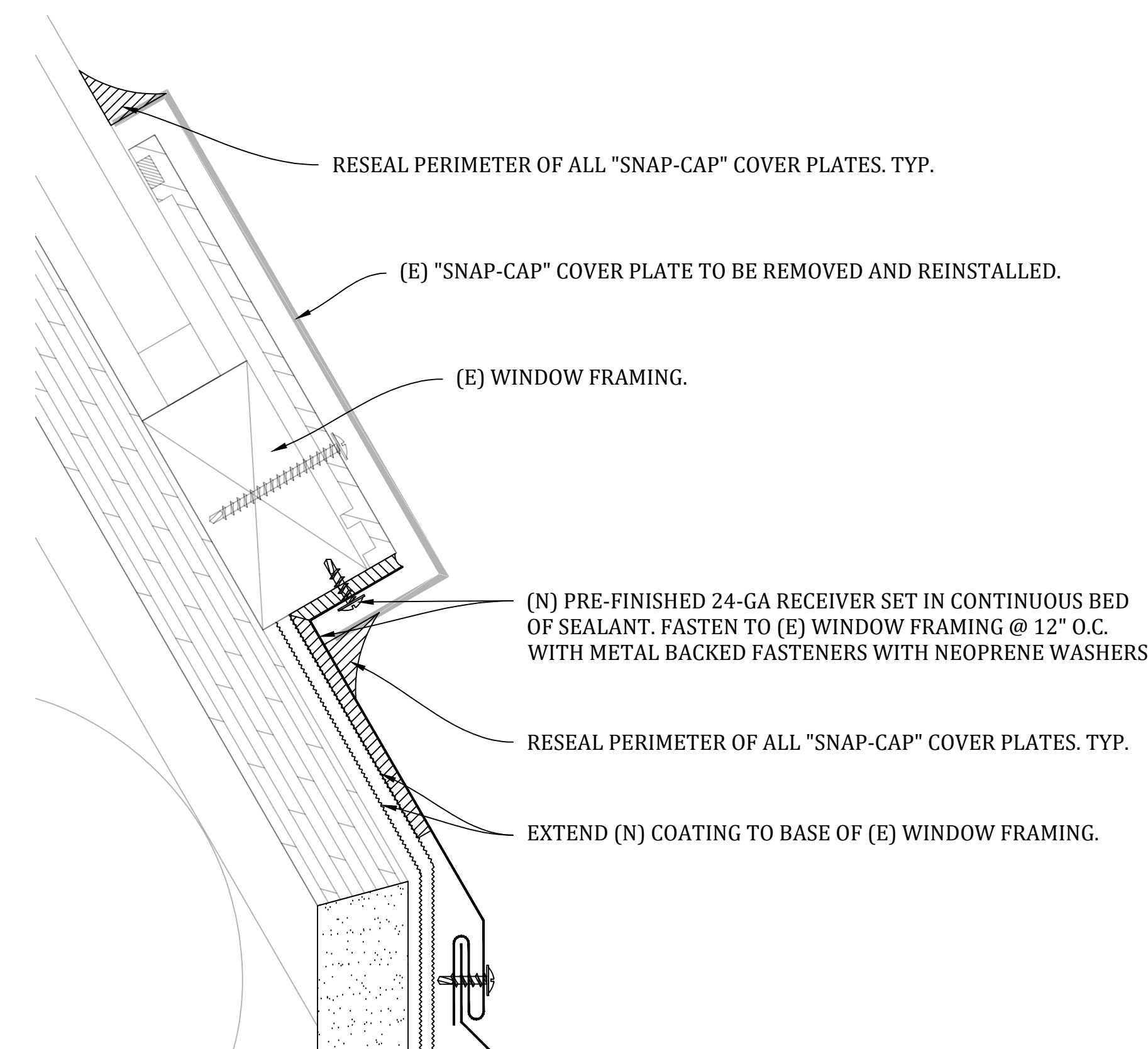

12 FLASHING REPAIR @ MONITOR CLEARSTORY WINDOWS (TYP)

SCALE: 1'-0" = 1'-0"

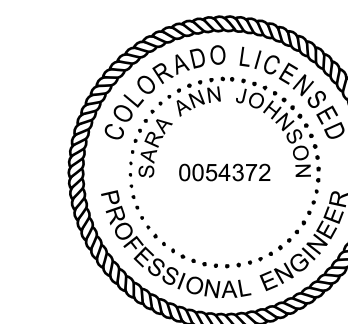

CLIENT
POUDRE SCHOOL DISTRICT R-1
2445 LAPORTE AVENUE
FORT COLLINS, COLORADO 80521

PROJECT
POUDRE SCHOOL DISTRICT R-1
ROOF RECOATING PROJECT

PROJECT NO. DEN.2019.001093

DATE 03/2020

DRAWN BY DD

CHECKED BY SAJ & RKP

DATE 03/26/2020

REVISION 01

AMTECH SOLUTIONS
1720 South Bellaire Street, Suite 1200
Denver, Colorado 80222
(303) 738-0823 | www.amtechsls.com

SHEET TITLE
ROOF DETAILS

SHEET NO.
R-501 05 OF 07